

LM Lock Bolt LMPCCZ

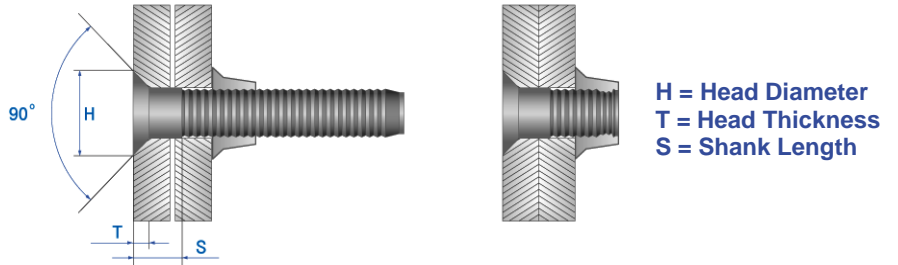

Head Type	Countersunk Head
Material	Carbon Steel
Finish	Zinc Plate



*Dimensions in millimeters

Part Number	Rivet Diameter (D) nom.	Hole Size	Shank Length(S) min.	Grip Range	Head Diameter (H) max.	Head Thickness (T) max.	Standard Strength (kN) typ.	
							Shear	Tensile
LMPCCZ-048023	4.8	4.8	4.3	2.4~15.9	8.8	2.2	8.2	10.0
LMPCCZ-048084			9.4	7.9~31.7				

Collar Type	Flange
Material	Carbon Steel
Finish	Zinc Plate

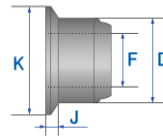

Part Number	Pin Diameter (D) nom.	F	G	H	J	K
LMFCZ-064000	6.4	6.5~6.8	10.2~10.4	8.8~9.7	1.1~2.0	12.2~13.2