

SUS Thin Sheet Half Hex Blind Nut **PMHSSP**

Body Type / Flange Type	Open End & Half Hex Body / Small Flange
Material	Stainless steel
Finish	Natural

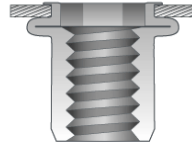
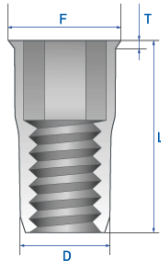

F = Flange Diameter
T = Flange Thickness
L = Body Length
D = Body Diameter

*Dimensions in millimeters

Part Number	Thread Size	D max.	Hole Size	L (±0.4)	Grip Range	F (±0.25)	T (±0.15)
PMHSSP-040020	M4 X 0.7	6.0	6.1	12.0	0.5~2.0	6.5	0.6
PMHSSP-050025	M5 X 0.8	7.0	7.1	14.0	0.5~2.5	7.5	0.6
PMHSSP-060025	M6 X 1.0	9.0	9.1	16.0	0.5~2.5	9.5	0.6
PMHSSP-080025	M8 X 1.25	11.0	11.1	17.0	0.5~2.5	11.5	0.6
PMHSSP-100030	M10 X 1.5	13.0	13.1	20.5	1.0~3.0	13.5	0.6

SUS Large Flange Half Hex Blind Nut **PMHLSP**

Body Type / Flange Type	Open End & Half Hex Body / Large Flange
Material	Stainless steel
Finish	Natural

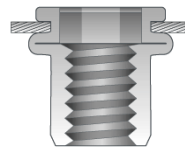
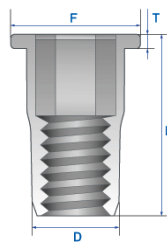

F = Flange Diameter
T = Flange Thickness
L = Body Length
D = Body Diameter

*Dimensions in millimeters

Part Number	Thread Size	D max.	Hole Size	L (±0.4)	Grip Range	F (±0.25)	T (±0.15)
PMHLSP-040020	M4 X 0.7	6.0	6.1	12.0	0.5~2.0	8.9	0.8
PMHLSP-050025	M5 X 0.8	7.0	7.1	14.0	0.5~2.5	10.0	0.9
PMHLSP-060025	M6 X 1.0	9.0	9.1	16.0	0.5~2.5	13.0	1.4
PMHLSP-080025	M8 X 1.25	11.0	11.1	17.0	0.5~2.5	16.0	1.6
PMHLSP-100030	M10 X 1.5	13.0	13.1	20.5	1.0~3.0	18.0	1.7